



Adelaide Arcade



FOR LEASE SHOP 12G

PROPERTY SUMMARY

Adelaide Arcade is Adelaide's most beautiful shopping arcade, offering a unique experience for the discerning. It has over 70 specialty retail and service outlets including six of the finest jewellers in the state. Between them they carry some of the worlds most sort after and precious gems from Argyle Pink Diamonds to the worlds best pearls. The unique mix includes Adelaide's best dry cleaner, clothing repairs and shoe repairs. Many other high quality services also call Adelaide Arcade home. The balcony level is occupied by a combination of office and retail tenants including podiatrist, IT consultants, website designers, graphic designer, Adelaide's only bespoke tailor, courtiers and artists creating beautiful jewellery and art objects. Cafés and chocolate shops headed by Haigh's add to the variety while different and exclusive gifts, watches, pens and Australian souvenirs are all part of Adelaide Arcade's unique offer.

SHOP 12G DETAILS

- Located at the entrance to Gay's Arcade which adjoins Adelaide Arcade, shop 12G has an excellent position with window exposure to both Gay's Arcade and Twin Street.
- Central location between Rundle Mall and Grenfell Street.
- Currently being renovated. Outstanding opportunity to be the first to occupy.
- Traffic volumes provide excellent exposure to passing shoppers.
- Air-conditioned.
- Shop size approx 59sqm
- Permitted use first floor: open to negotiation.
- Rental open to negotiation depending on terms and length of lease.

AGENT DETAILS
Evans & Ayers Pty Ltd
RLA 213689

GPO Box 460
Adelaide
5001

Phone: 8223 5522
Facsimile: 8223 1963
Email: mail@adelaidearcade.com.au

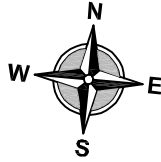

**PCA LEASE PLAN
SHOP 12G
IN THE AREA NAMED
GAYS ARCADE
ADELAIDE**

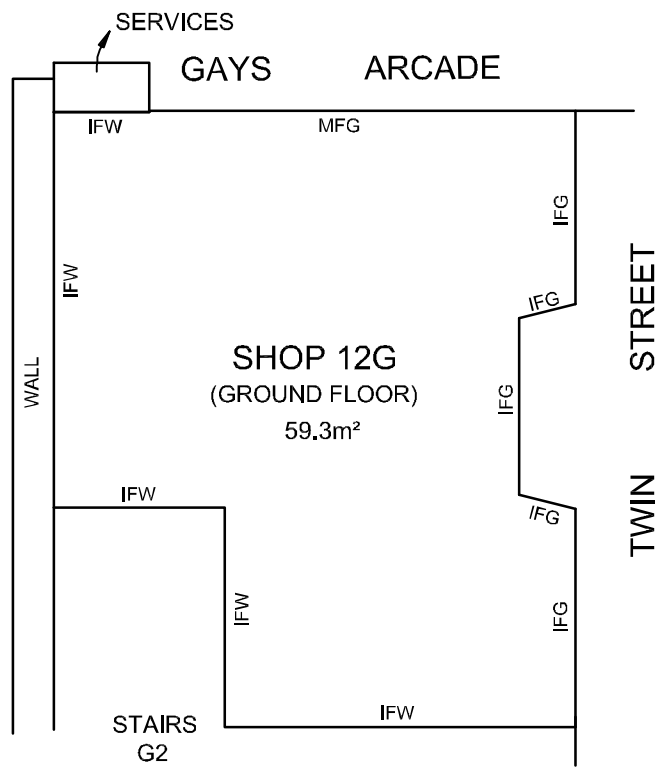

PCA Schedule of Areas

SHOP 12G (Ground Floor)

Total G.L.A.R SHOP 12G 59.3m²

Legend

IFW denotes Inside face of wall

IFG denotes Inside face of glass

MFG denotes Mall Line face of glass

Alexander & Symonds Pty Ltd
11 King William Street Kent Town,
South Australia 5067
PO Box 1000 Kent Town, SA 5071
DX 209 ABN 93007 753 988

T (08) 8130 1666
F (08) 8362 0099
W www.alexander.com.au
E adel@alexander.com.au

+ Property + Land Development +
+ Construction + Mining +
+ Spatial Information Management +



Property Council of Australia (PCA) Notes:

1. AREAS AND TENANCY BOUNDARIES HAVE BEEN DEDUCED IN ACCORDANCE WITH, AND UNDER INTERPRETATION OF THE PROPERTY COUNCIL OF AUSTRALIA METHOD OF MEASUREMENT, REVISED EDITION, MARCH 1997 PART 2 GROSS LETTABLE AREA RETAIL (G.L.A.R).

2. ALL PARTIES USING THE AREAS EXPRESSED UPON THIS SKETCH SHOULD AGREE WITH THE BOUNDARY DELINEATIONS.



SCALE 1:100 METRES
AT ORIGINAL SHEET SIZE A4

Glenn Ian Hordacre

LICENSED SURVEYOR

REFERENCE A099208.00

DWG No A099208PCA SHOP 12G (rev a)

FIELD BOOK KJD

KJD 21.10.2009